

**Cube 4**  
**Series 700 (Cube)**

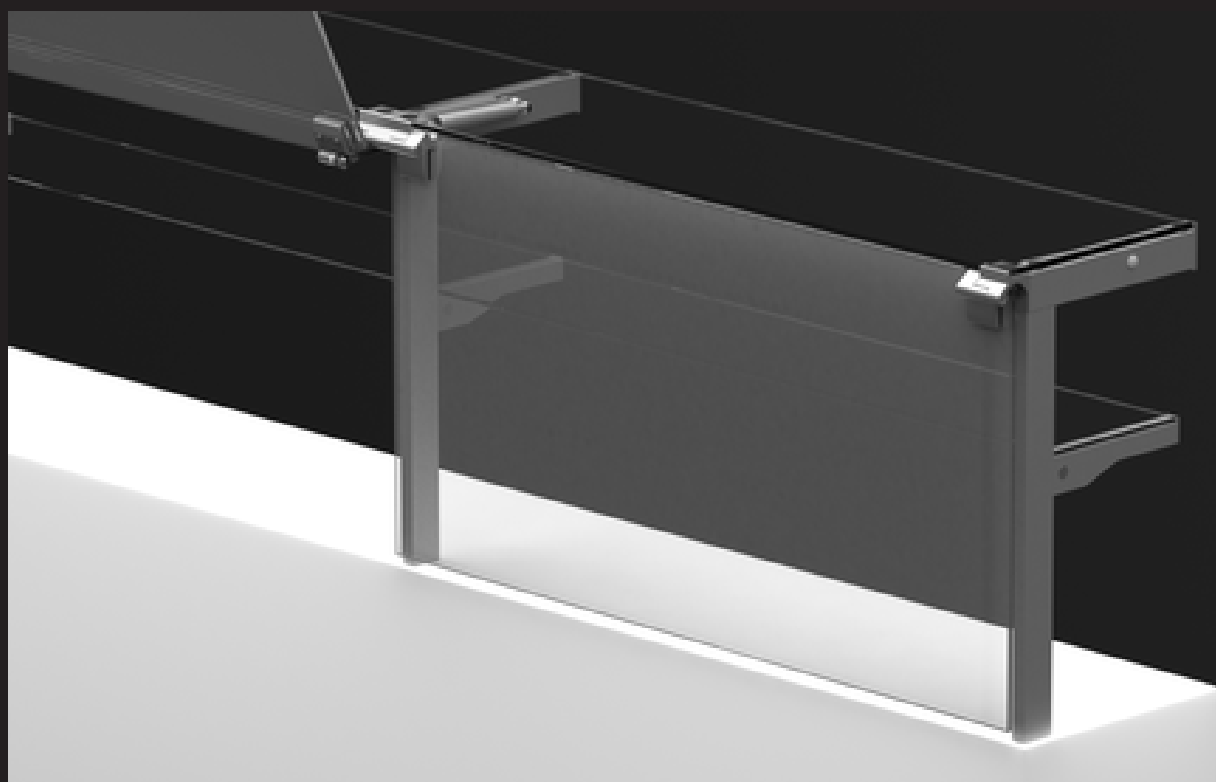

## Product characteristics

- strut position according to request (front / center / rear)
- front glass liftable or as door solution
- top service plate fixed or liftable
- simple corner solutions with doors
- optional damping of glasses on closing
- intermediate supports on request
- lighting T5, T8 or LED

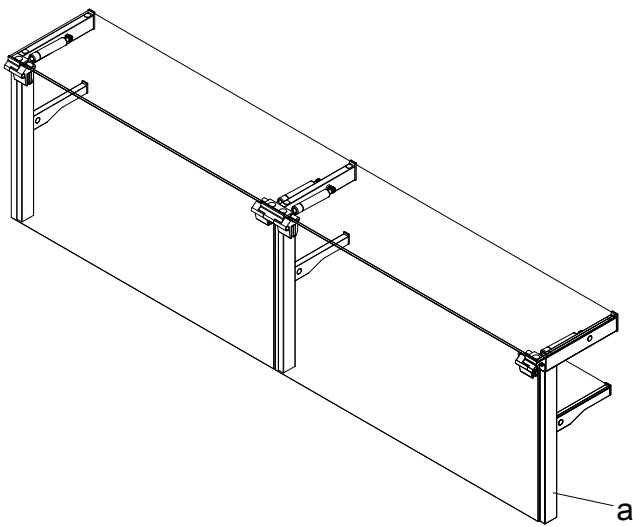

a) Front strut

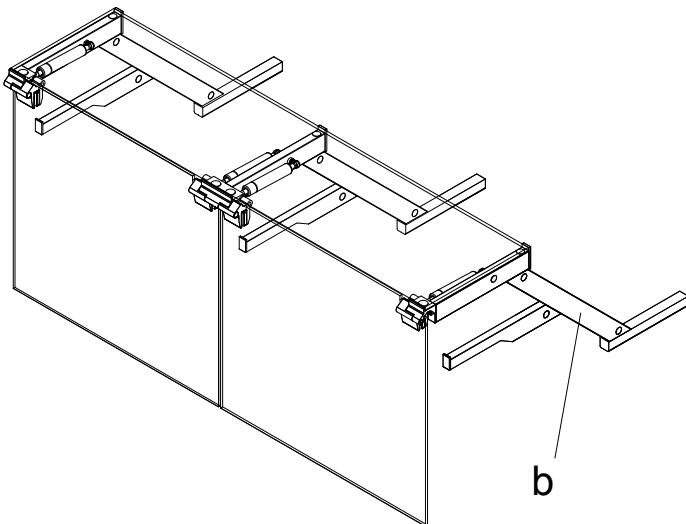

b) Rear strut

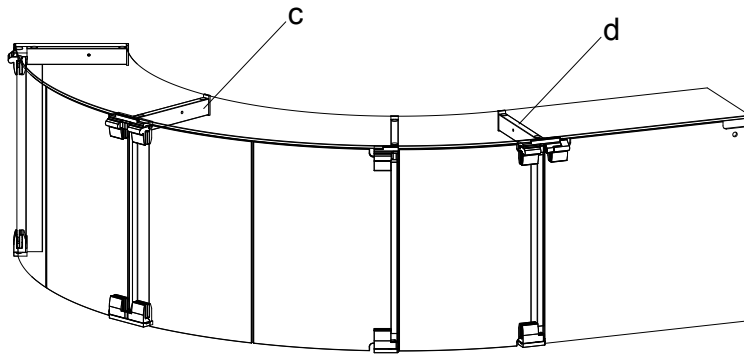

c) Front system door    d) Combined system door front strut

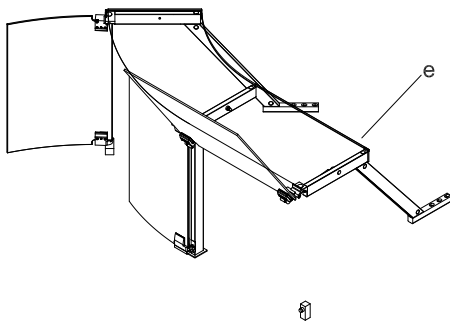

e) Combined system door rear strut

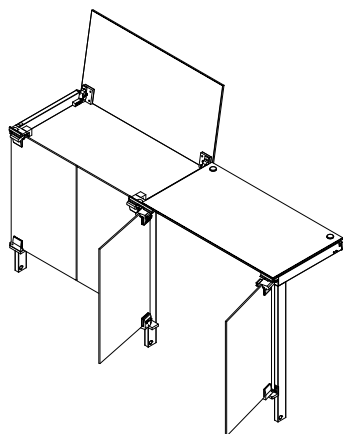

System door, front strut with liftable top service plate

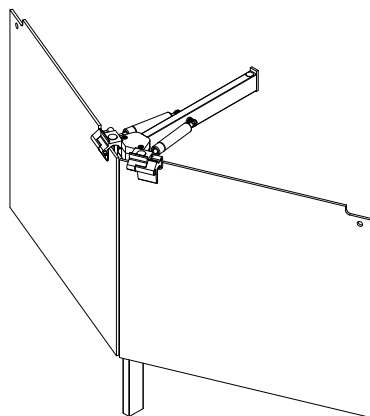

Front strut 45°

**Program supplement for circle segment and spherical glass:**

Series 600 (same strut profile grants use of struts with different geometry on the same case body)

## Planning information

- front glass 6 mm tempered  
height max. 700 mm, length max. 1800 mm
- top service plate 8 mm tempered, depth max. 500 mm
- additional rear strut needed for top service plate exceeding 500 mm
- opening angle 160°
- front glass on opening and closing supported by gas rams
- optional light canopy
- individual assembly to case body
- strut can be placed in nearly any position to support

### Geometry and glass cut-out

- Frontglass end and center strut

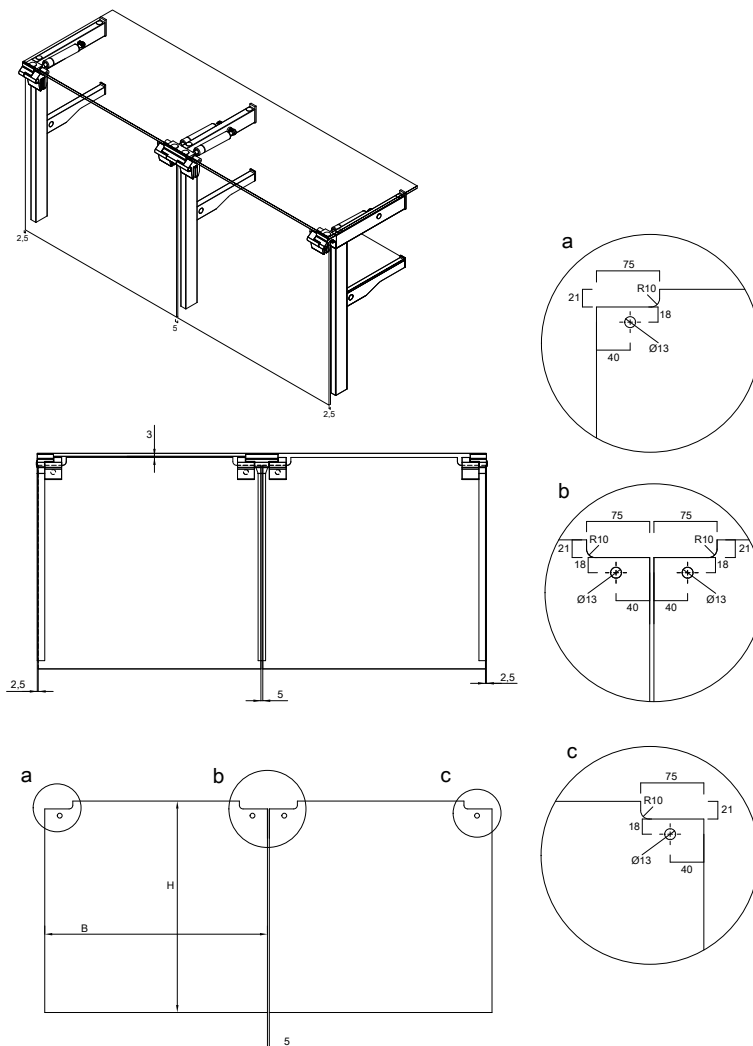

■ Front glass external corner 45°

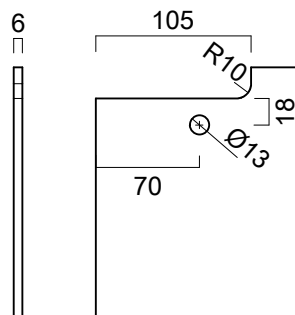
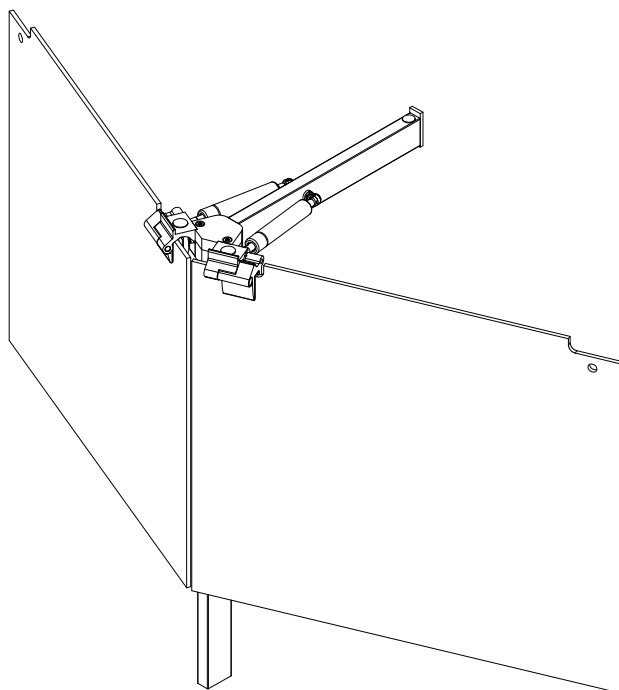

■ Liftable top plate

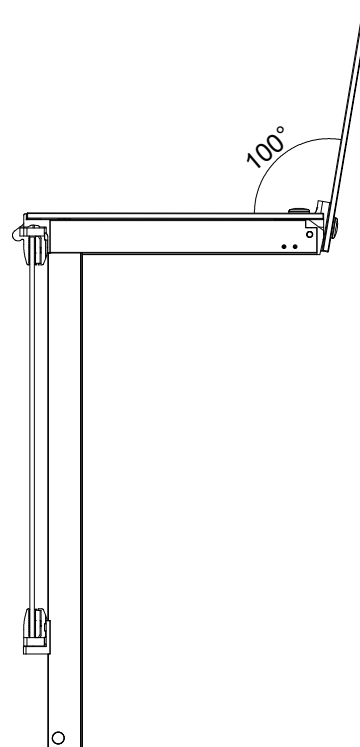
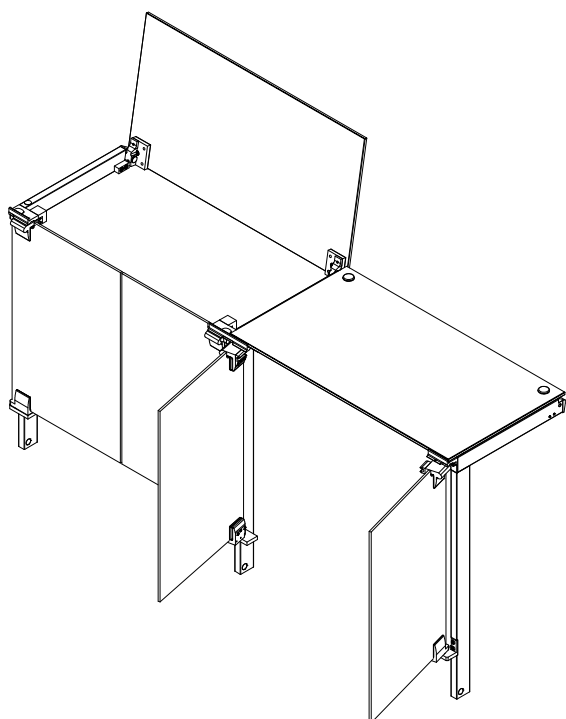

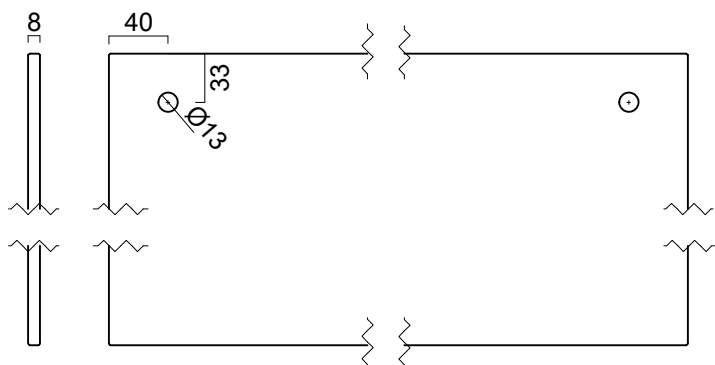

## **System doors for corners**

### ■ **External corner**

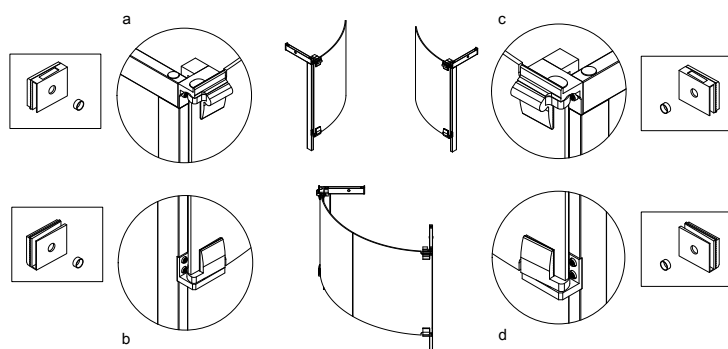

### ■ **Internal corner**

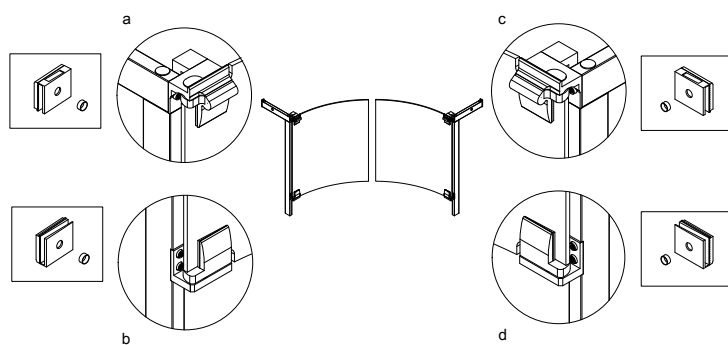

■ System door 45°

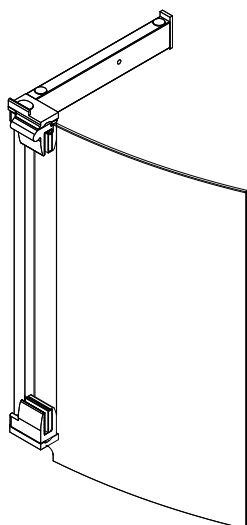

System door closed.

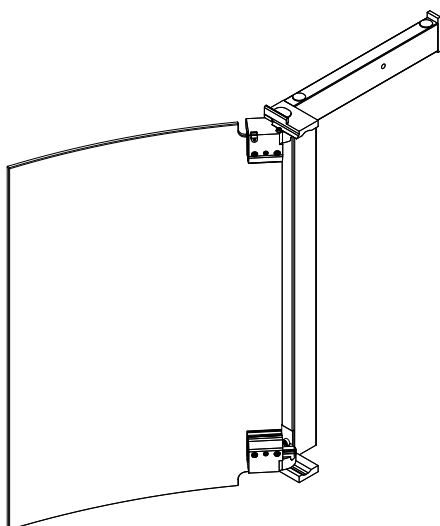

System door open.

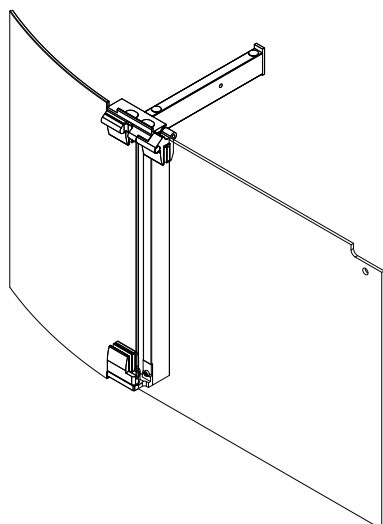

Combined system door closed.

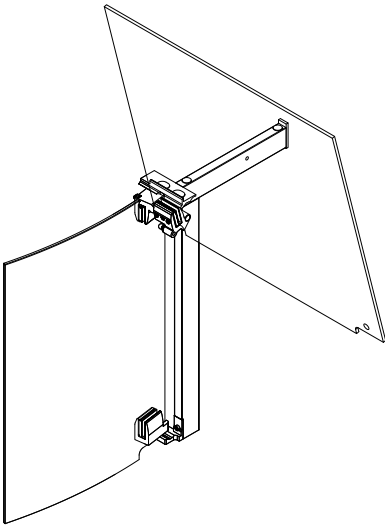

Combined system door open.

**Strut fixing**

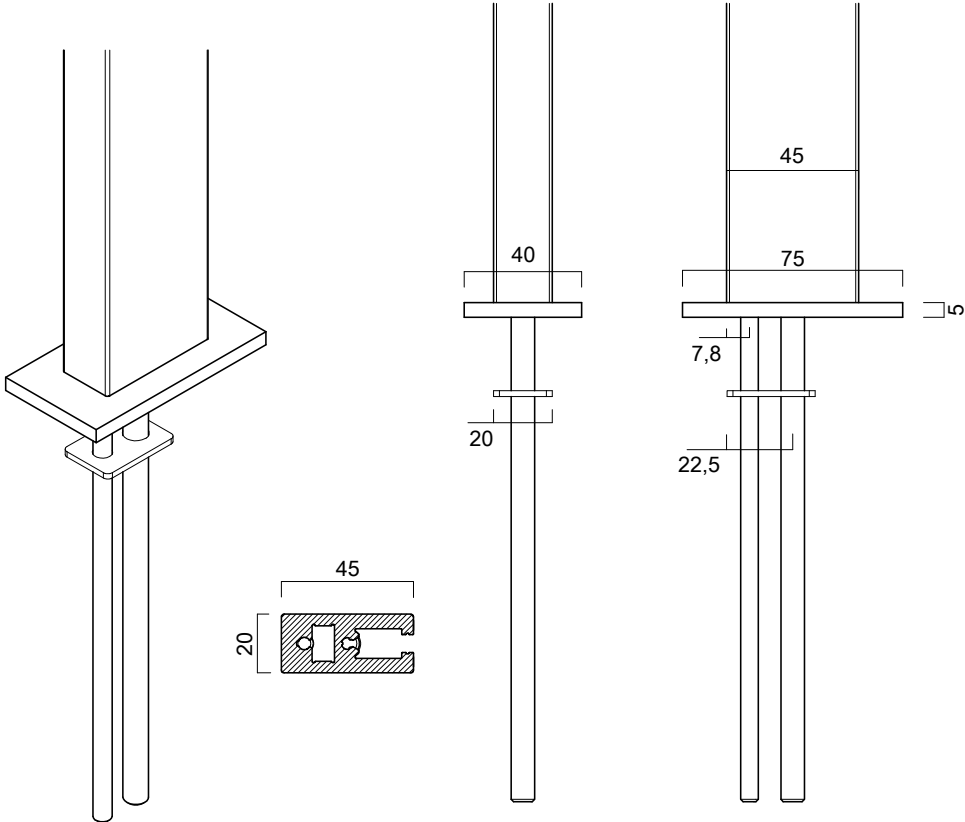



# Example of a case line-up

- a) Customer side    1) Strut left
- b) Internal corner    2) Strut right
- c) External corner    3) Strut center

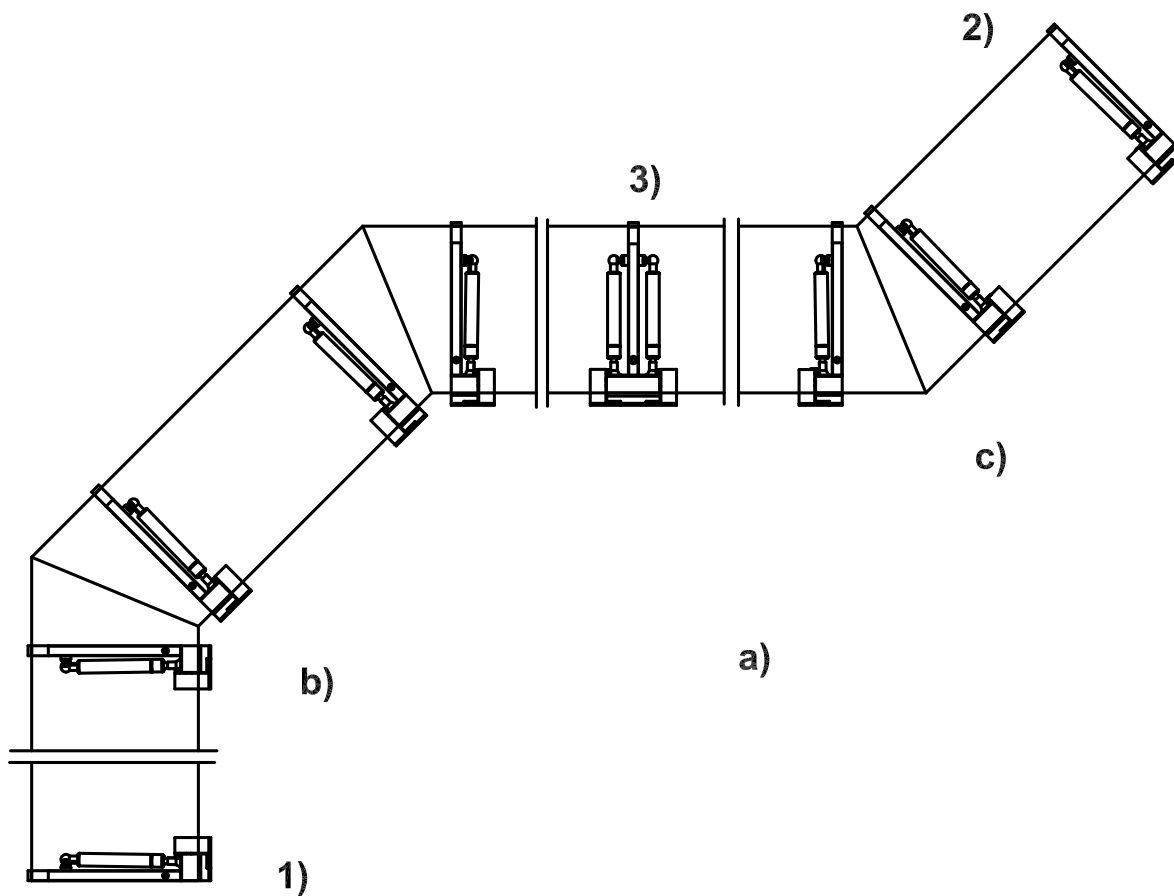

## Purchasing information

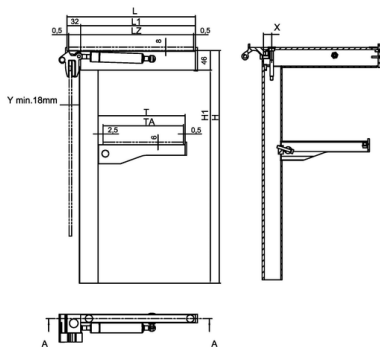

In case of order please name the following dimensions:

- Depth of top service plate [LZ] (glass depth)
- Height up to bottom edge of top service plate [H]
- Distance of front glass to strut [Y]
- Dimensions of front glass for calculation of gas ram force [N]  
 Glass height [mm]  
 Glass length [mm]

For an intermediate support, please name depth of glass plate [TA]

***Your advantage: nearly every position of support in relation to strut is possible, according to your request.***

**LZ = Depth of top service plate (glass depth)**

$L_1$  = Length of support profile section

L = Length of top service plate glass

**H** = Height up to bottom edge of top service plate

H1 = Length of strut profile section

**Y = Distance of front glass to strut**

X = Position of screws

**TA = Depth of glass**

$T$  = Length of intermediate support profile section

### Gas ram force (N) for standard glass dimensions

(Calculation of force without hand grip)

	Length [mm]				
Height [mm]	850	1000	1250	1500	1800
400	2x400	2x400	2x400	2x500	2x500
450	2x500	2x500	2x500	2x500	2x600
500	2x500	2x600	2x600	2x600	2x800

## Cube 4

Picture

### Product

### Part number

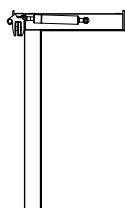
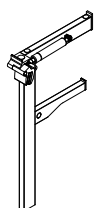

**Cube 4, lift-up, front strut**  
Strut 700 mm  
Support 500 mm  
  
Option: liftable top plate

left **07.447.4001.XXX**

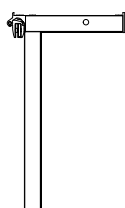
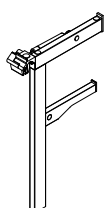

**Cube 4, lift-up, front strut**  
Strut 700 mm  
Support 500 mm  
  
Option: liftable top plate

right **07.447.4002.XXX**

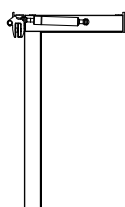
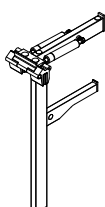

**Cube 4, lift-up, front strut**  
Strut 700 mm  
Support 500 mm  
  
Option: liftable top plate

center **07.447.4003.XXX**

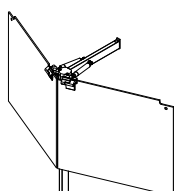

**Cube 4, lift-up, front strut, center 45°**  
Strut 700 mm  
Support 500 mm  
  
Option: liftable top plate

**07.447.40XX.XXX**

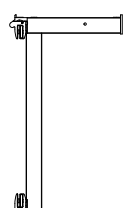
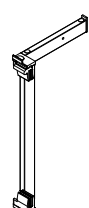

**Cube 4, combined system door, front strut**  
for straight or bent glass  
  
Strut 700 mm  
Support 500 mm  
  
Option: liftable top plate

left **07.447.4007.XXX**

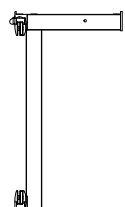
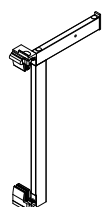

**Cube 4, system door, front strut**  
for straight or bent glass  
  
Strut 700 mm  
Support 500 mm  
  
Option: liftable top plate

right **07.447.4008.XXX**

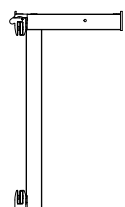
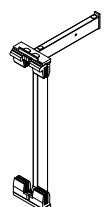

**Cube 4, system door, front strut**  
for straight or bent glass  
  
Strut 700 mm  
Support 500 mm  
  
Option: liftable top plate

center **07.447.4009.XXX**

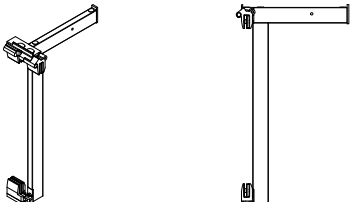
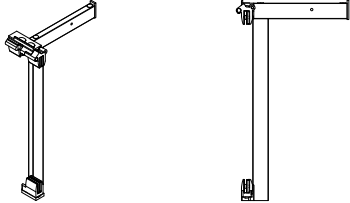
Picture	Product	Part number
	<b>Cube 4, combined system door, front strut</b> for straight or bent glass  Strut 700 mm Support 500 mm  Option: liftable top plate	left <b>07.447.4005.XXX</b>
	<b>Cube 4, combined system door, front strut</b> for doors with bent glass	right <b>07.447.4006.XXX</b>

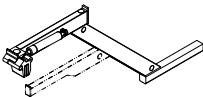
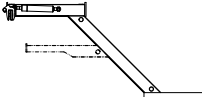
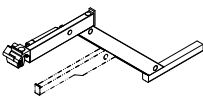
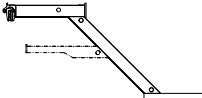
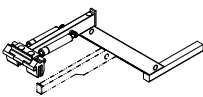
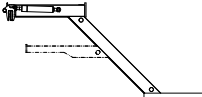
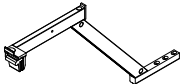
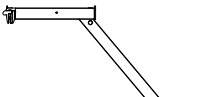
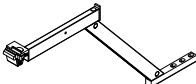
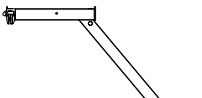
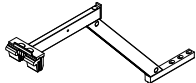
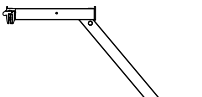
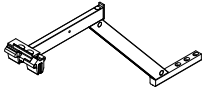
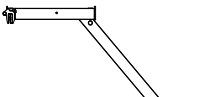
Picture	Product	Part number
 	<b>Cube 4, lift-up, rear strut</b> for straight cases with or without intermediate support  Strut 700 mm Support 500 mm  Option: liftable top plate	left <b>07.447.4041.XXX</b>
 	<b>Cube 4, lift-up, rear strut</b> for straight cases with or without intermediate support  Strut 700 mm Support 500 mm  Option: liftable top plate	right <b>07.447.4042.XXX</b>
 	<b>Cube 4, lift-up, rear strut</b> for straight cases with or without intermediate support  Strut 700 mm Support 500 mm  Option: liftable top plate	center <b>07.447.4043.XXX</b>
 	<b>Cube 4, system door, rear strut</b> incl. bottom hinge for straight or bent glass  Strut 700 mm Support 500 mm  Option: liftable top plate	left <b>07.447.4057.XXX</b>
 	<b>Cube 4, system door, rear strut</b> incl. bottom hinge for straight or bent glass  Strut 700 mm Support 500 mm  Option: liftable top plate	right <b>07.447.4058.XXX</b>
 	<b>Cube 4, system door, rear strut</b> incl. bottom hinge for straight or bent glass  Strut 700 mm Support 500 mm  Option: liftable top plate	center <b>07.447.4059.XXX</b>
 	<b>Cube 4, combined system door, rear strut</b> incl. bottom hinge  Strut 700 mm Support 500 mm  Option: liftable top plate	left <b>07.447.4055.XXX</b>

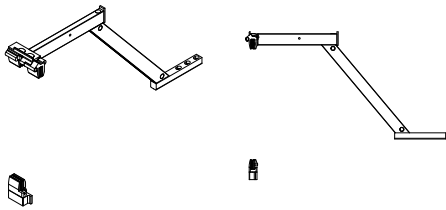
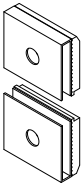
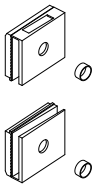
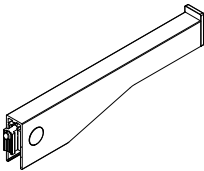
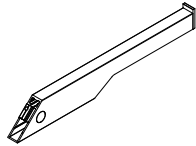
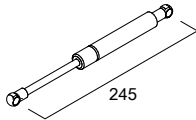
Picture	Product	Part number
	<b>Cube 4, combined system door, rear strut</b> incl. bottom hinge  Strut 700 mm Support 500 mm  Option: liftable top plate	right <b>07.447.4056.XXX</b>
	<b>Cube 4, clamp plate set</b> for doors with straight glass	<b>447.4430.000</b>
	<b>Cube 4, clamp plate set</b> for doors with bent glass	<b>447.4431.000</b>
	<b>Cube 4, intermediate support for front strut, L=400 mm</b> pls indicate required length with order	<b>07.447.4330.XXX</b>
	<b>Cube 4, intermediate support for rear strut, L=508 mm</b> pls indicate required length and angle with order	<b>07.447.4331.XXX</b>
	<b>Gas ram Lift-O-Mat</b>	100N <b>14.044.3218.051</b> 200N <b>14.044.3294.051</b> 250N <b>14.044.3295.051</b> 300N <b>14.044.3267.051</b> 400N <b>14.044.3268.051</b> 500N <b>14.044.3269.051</b> 600N <b>14.044.3270.051</b> 700N <b>14.044.3271.051</b> 800N <b>14.044.3296.051</b> 900N <b>14.044.3689.051</b> 1,000N <b>14.044.3690.051</b> 1,100N <b>14.044.3691.051</b> 1,200N <b>14.044.3692.051</b>

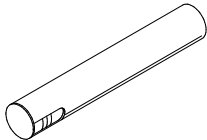
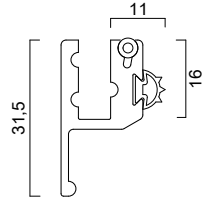
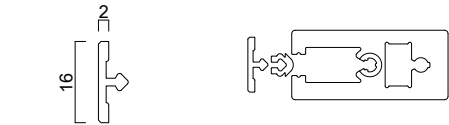
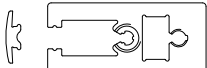
Picture	Product	Part number
	<b>Cover for gas ram</b> for straight case 14.446.6008.XXX for gas rams including 800 N	external corner <b>14.446.6008.XXX</b> internal corner <b>14.446.6009.XXX</b>
	<b>Hand grip profile</b> complete	5000mm <b>07.447.5300.XXX</b>
	<b>Cube 4 Profile cut</b> out of profile 052.3464.000 pls indicate required length	<b>07.447.4306.XXX</b>
	<b>Cover profile</b> anodized aluminum	5000mm <b>07.052.8184.XXX</b>
	<b>Silicone profile</b> for fixing of cover profile 052.8184.XXX	5000mm <b>07.054.0555.084</b>
	<b>Cover profile</b> silicone profile, with talcum, color RAL 7035, coil of 100 m packed in crates	<b>07.054.0554.084</b>
	<b>Strut fixing</b>	<b>07.044.4742.070</b>

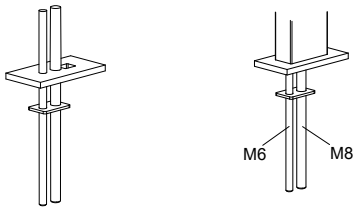
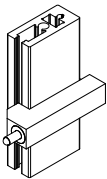
Picture	Product	Part number
	<b>Fixing with thread bar with threaded rods</b>	<b>07.447.4324.070</b>
	<b>Cube 4 Damper unit</b>	<b>07.447.4300.XXX</b>